

FOR LEASE | OFFICE

125 S. MAIN STREET
ANN ARBOR, MI 48104



PROPERTY HIGHLIGHTS

Premier office/retail opportunity in the heart of downtown Ann Arbor, MI. The property caters to a population of 53,000 University of Michigan students and over 160,000 residents in a 5-mile radius. This flagship location is ideal for a restaurant, clothing store or home goods store.

PROPERTY SUMMARY

Price / SF:	Inquire
Building Size:	Approx. 40,000 SF
Space Available:	Up to 40,000 SF
Property Type:	Retail/Office



1st FLOOR PLAN

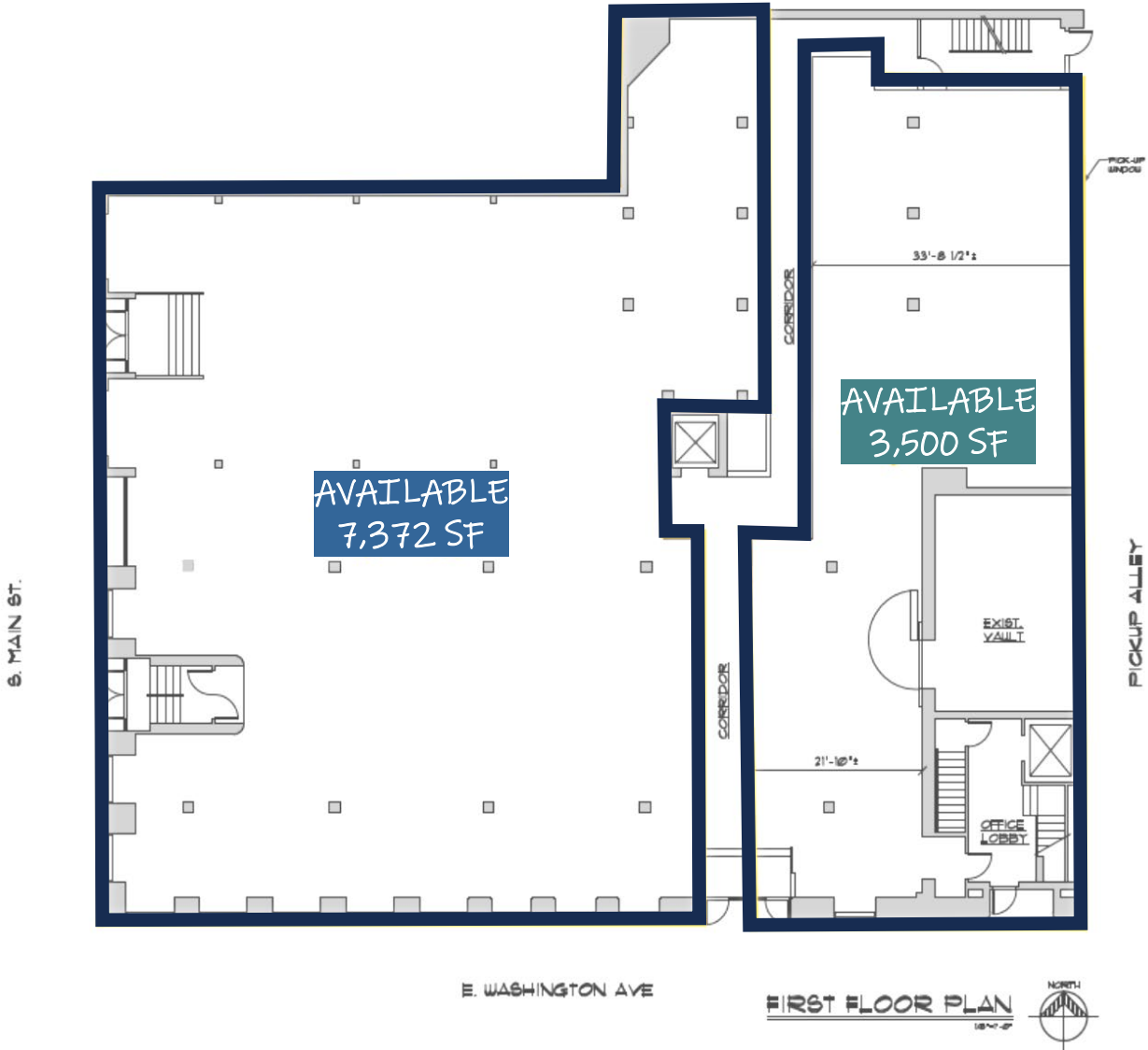

E. WASHINGTON AVE

FIRST FLOOR PLAN
NORTH

